

CITY OF MUSKEGON
PLAN AND PROFILE OF PROPOSED
CITY PARK PARKING LOT IMPROVEMENTS
SP92339

CJ REESE PARK

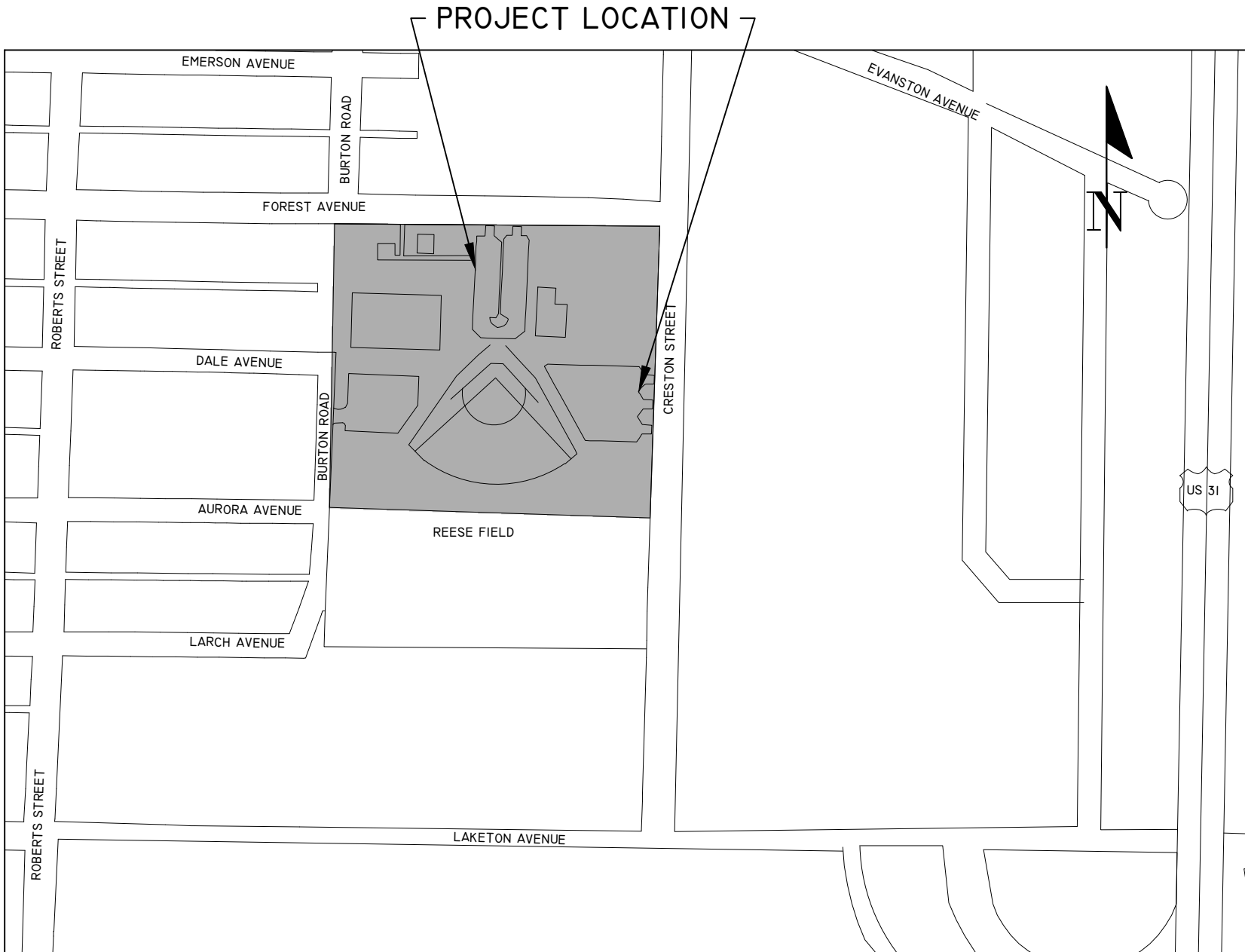

SHELDON PARK



BEUKEMA PLAYFIELD



GRAND TRUNK BOAT RAMP

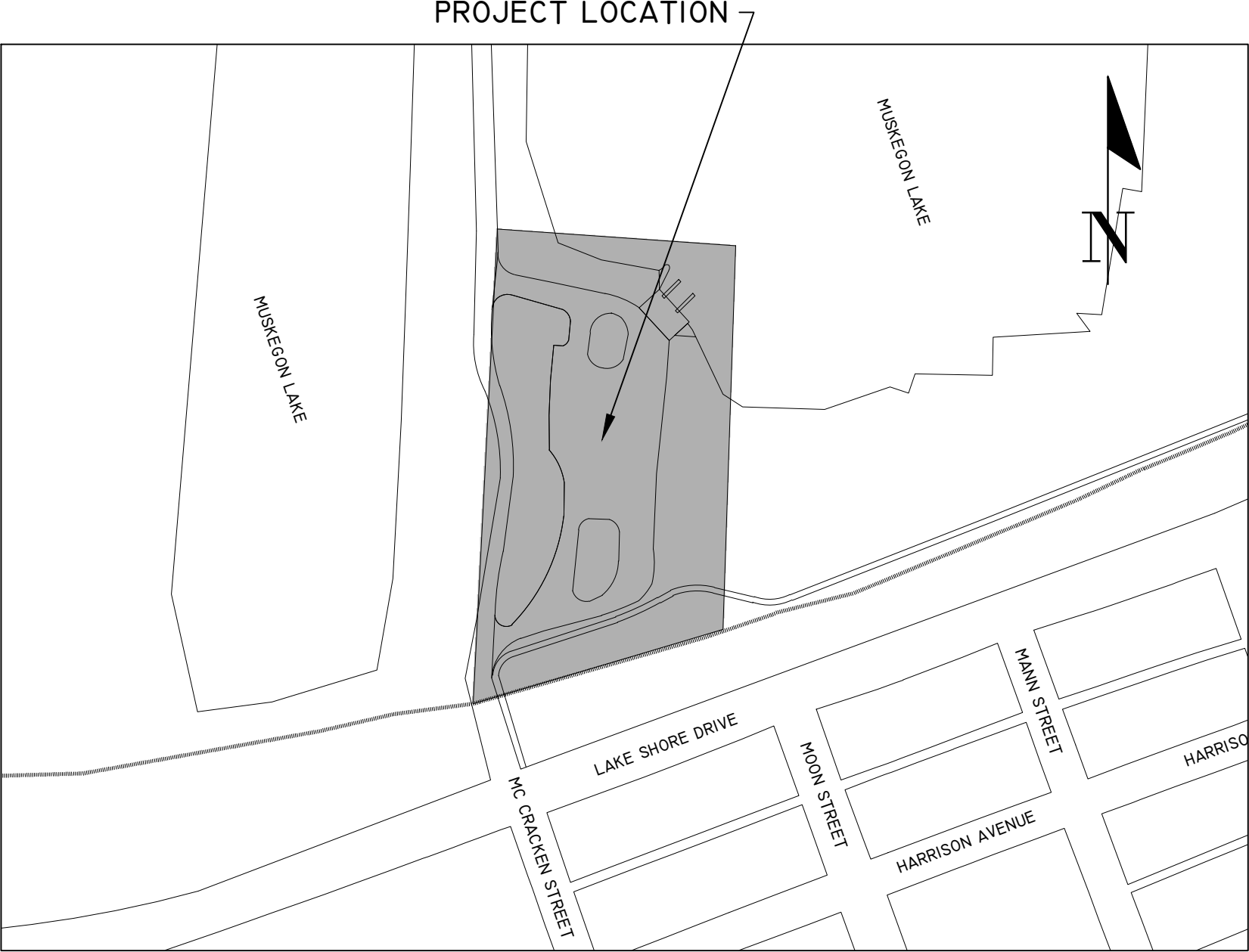

SHEET INDEX

SHEET	DESCRIPTION
1.	TITLE SHEET
2.	CJ REESE PARK
3.	SHELDON PARK
4.	BEUKEMA PLAYFIELD
5.	GRAND TRUNK PARKING AREA

NOTE:

THE IMPROVEMENTS COVERED BY THESE PLANS SHALL BE DONE IN ACCORDANCE WITH THE MICHIGAN DEPARTMENT OF TRANSPORTATION 2020 STANDARD SPECIFICATIONS FOR CONSTRUCTION AND THE 2011 MICHIGAN MANUAL OF UNIFORM TRAFFIC CONTROL DEVICES. THESE IMPROVEMENTS HAVE BEEN DESIGNED IN ACCORDANCE WITH THE 2018 AASHTO GUIDELINES.

GENERAL NOTES:

- EXISTING CONDITIONS INCLUDING ELEVATIONS ARE SUBJECT TO CHANGE DUE TO CONSTRUCTION OUTSIDE THE CONTROL OF THE CITY OF MUSKEGON. CONTRACTOR IS TO VERIFY EXISTING CONDITIONS OF THE SITE, MATCH ALL EXISTING MEETS AND COORDINATE WORK ACTIVITIES WITH NEIGHBORING CONTRACTORS.
- UPON REQUEST AND APPROVAL, THE CONTRACTOR MAY OBTAIN A WATER SUPPLY FROM THE CITY OF MUSKEGON FIRE HYDRANTS AT NO COST, PROVIDED THAT THEY FOLLOW THE CONDITIONS OF THE CITY WATER DEPARTMENT.
- FOR PROTECTION OF UNDERGROUND UTILITIES, THE CONTRACTOR SHALL CALL MISS DIG, 1-800-482-7171, A MINIMUM OF 3 WORKING DAYS EXCLUDING SATURDAYS, SUNDAYS, AND HOLIDAYS PRIOR TO EXCAVATING IN THE VICINITY OF ALL UTILITY LINES. ALL MISS DIG PARTICIPATING MEMBERS WILL BE NOTIFIED, THIS DOES NOT RELIEVE THE CONTRACTOR OF THE RESPONSIBILITY OF NOTIFYING OWNERS WHO MAY NOT BE PART OF THE MISS DIG ALERT SYSTEM.
- PUBLIC UTILITIES OF ALL TYPES HAVE BEEN SHOWN ON THE PLAN USING AVAILABLE INFORMATION, BUT ARE NOT GUARANTEED AS ACCURATE OR THAT UTILITIES OTHER THAN THOSE SHOWN ARE NOT PRESENT.
- THE CONTRACTOR SHALL SAW CUT ALL MEETS RELATIVE TO SIDEWALK OR PAVEMENT CONSTRUCTION UNLESS WAIVED BY THE ENGINEER. PAYMENT FOR SAW CUTTING SHALL BE INCLUDED IN THE PAYMENT FOR THE PAY ITEMS PAVT, REM, MODIFIED; CURB AND GUTTER, REM; AND/OR SIDEWALK, REM. NO ADDITIONAL PAYMENT WILL ALLOWED FOR SAW CUTTING.
- THE CONTRACTOR SHALL PREVENT EROSION AND CONTROL SEDIMENTATION ASSOCIATED WITH THE PROJECT. KEEP SEDIMENTATION WITHIN THE RIGHT OF WAY (OR CONSTRUCTION LIMITS) AND OUT OF SURFACE WATERS. CONSTRUCT AND MAINTAIN TEMPORARY EROSION AND SEDIMENTATION CONTROLS, TO INCLUDE INLET PROTECTION, FABRIC DROPS ON ALL INLET STRUCTURES NEW AND EXISTING AND INSTALL TEMPORARY EROSION, SEDIMENTATION CONTROLS AS DIRECTED BY THE ENGINEER. THE CONTRACTOR SHALL REMOVE ON A DAILY BASIS SOIL TRACKED ONTO EXISTING PAVED ROADS, (VACUUM METHODS ARE PREFERRED BUT BROOM SWEEPING IS ACCEPTABLE IF THE MATERIAL IS REMOVED) THE CONTRACTOR SHALL INSPECT ALL SOIL EROSION / SEDIMENTATION CONTROL MEASURES ON A WEEKLY BASIS OR AFTER EACH RAIN FALL. EVENT, CLEAN REPAIR, OR REPLACE, AS NECESSARY, TO ENSURE PROPER FUNCTION. ALL SOIL EROSION / SEDIMENTATION CONTROLS SHALL REMAIN UNTIL ALL DISTURBED AREAS ARE STABILIZED. ALL SOIL EROSION / SEDIMENTATION CONTROL, EXCEPT FOR THE EROSION CONTROL, INLET PROTECTION, FABRIC DROP AND SILT FENCE SHALL BE INCLUDED WITH THE PAY ITEM PROJECT CLEAN UP. NO OTHER PAYMENT SHALL BE MADE.

UTILITIES

ELECTRIC
JOEL BROWN
CONSUMERS ENERGY
700 E STERNBERG ROAD
NORTON SHORES, MI 49441
(231) 332-2682

TELEPHONE
MIKE THOMPSON
FRONTIER COMMUNICATIONS
(231) 740-4275
MICHAEL.X.THOMPSON@FTR.COM

NATURAL GAS
ANTHONY (TONY) FERRIER
DTE ENERGY
2359 OLTHOFF DRIVE
MUSKEGON MI 49444
(231)726-0943 (CELL)
ANTHONY.FERRIER@DTEENERGY.COM

CABLE
JASON BROWN
COMCAST
700 W BROADWAY AVE
MUSKEGON, MI 49441
810-217-1642
JASON_BROWN6@COMCAST.COM

WATER & SEWER
CITY OF MUSKEGON - DPW
1350 E KEATING AVENUE
MUSKEGON MI 49442
(231) 724-4100



3 WORKING DAYS
EXCLUDING SAT, SUN & HOLIDAYS
BEFORE YOU DIG
CALL MISS DIG

CONSTRUCTION INCLUDES

PARKING AREA IMPROVEMENTS IN THE CITY OF MUSKEGON, MUSKEGON COUNTY.
IMPROVEMENTS INCLUDE CONCRETE AND HMA REMOVALS, PULVERIZING, GRADING,
CURB, SIDEWALK, AND HMA PAVING

PREPARED UNDER THE SUPERVISION OF:

DAN VANDERHEIDE, P.E.
CITY ENGINEER

CITY OF MUSKEGON
ENGINEERING DEPARTMENT
1350 E KEATING AVE
MUSKEGON MI 49442

REGISTRATION NUMBER

CITY OF MUSKEGON
OFFICE OF THE CITY ENGINEER

PARKS PARKING LOT
IMPROVEMENTS

DRAWN	K PARKER	1/2025	REVISION	—	SURVEY	FP/JB	2024	PROJECT NO
CHECKED			REVISION		AS-BUILT			SP 92339
APPROVED			REVISION					SHEET NO. 1 COVER

CJ REESE PARK PARKING AREA

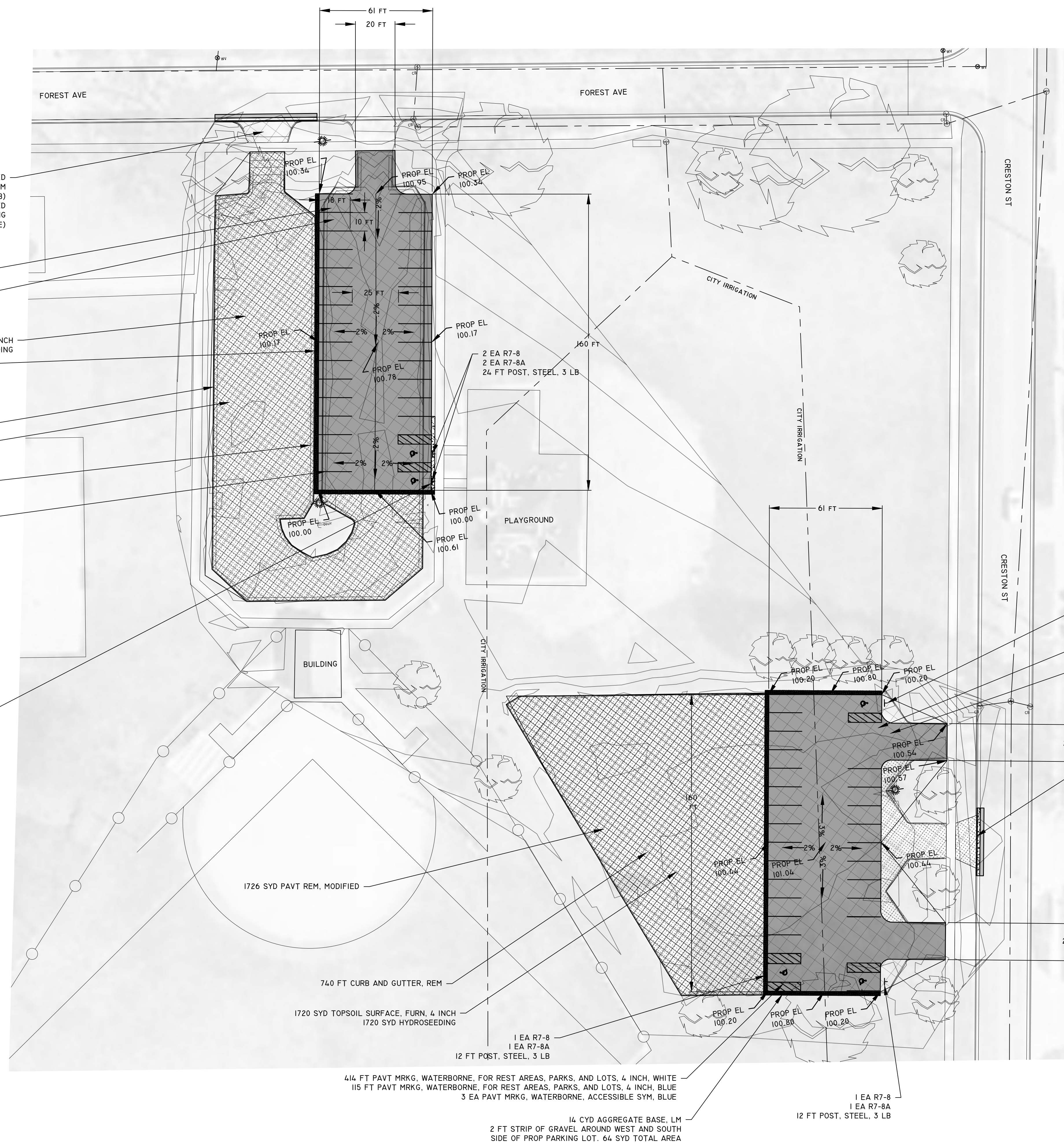



CONSTRUCTION NOTE: AREA OF EXISTING PARKING LOT TO BE PAVED AS NEW LOT WILL BE PAID AS HMA BASE CRUSHING AND SHAPING BY SYD IN TO ACHIEVE FINISH GRADE FOR HMA. AREA OF EXISTING LOT THAT WILL BE NEW GREEN SPACE WILL BE PAID AS PAVT REM MODIFIED BY SYD. PAVT REM MODIFIED SHALL INCLUDE REMOVAL OF EXISTING HMA AND GRAVEL 6 INCHES BELOW EXISTING ELEVATION. CLASS II FILL WILL BE PLACED BY CYD TO ACHIEVE SUBGRADE BELOW 4 INCHES OF TOPSOIL. HMA AND GRAVEL SHALL BE SOFTENED BY CYD TO ACHIEVE FINISH GRADE. TO ACHIEVE GRADE IN AREAS GETTING PAVED WITH HMA, REMAINING MATERIAL, APPROX 562 CYD IN TOTAL WILL BECOME PROPERTY OF CONTRACTOR.

ELEVATION CONTOURS SHOWN ARE EXISTING

PERMANENT SIGN QUANTITIES THIS SHEET						
SIGN	TYPE	DESCRIPTION	QUANTITY	DIM	AREA	TOTAL
R7-8	TYPE (IIB)	RESERVED PARKING HCP	5	12X18	1.5 SFT	7.5 SFT
R7-8A	TYPE (IIB)	VAN ACCESSIBLE	5	6X12	.5 SFT	2.5 SFT
					TOTAL	10 SFT
		POST, STEEL, 3 LB	5		12 FT EA	60 FT

QUANTITIES THIS SHEET		
DESCRIPTION	QUANTITY	UNIT
CURB AND GUTTER, REM	1919	FT
PAVT REM, MODIFIED	3451	SYD
HMA BASE, CRUSHING AND SHAPING	2283	SYD
AGGREGATE BASE, LM	26	CYD
HMA, 4EML BASE AND LEVELING (1.5 INCHES; 165#/(SYD))	190	TON
HMA, 4EML TOPCOURSE (1.5 INCHES; 165#/(SYD))	190	TON
HANDPATCHING	4.5	TON
SIDEWALK, CONC, 4 INCH	76	SFT
CURB AND GUTTER CONC DET F4	91	FT
GRANULAR MATERIAL CLASS II	515	CYD
TOPSOIL SURFACE, FURN, 4 INCH	2980	SYD
HYDROSEEDING	2980	SYD
SIGN, TYPE IIIIB	10	SFT
POST, STEEL, 3 LB	60	FT
PAVT MRKG, WATERBORNE, FOR REST AREAS, PARKS, AND LOTS, 4 INCH, WHITE	1044	FT
PAVT MRKG, WATERBORNE, FOR REST AREAS, PARKS, AND LOTS, 4 INCH, BLUE	212	FT
PAVT MRKG, WATERBORNE, ACCESSIBLE SYM, BLUE	5	EA
TRAFFIC CONTROL (5% MAX)	1	LSUM

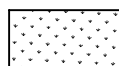
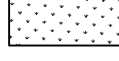
	HMA BASE CRUSHING AND SHAPING
	PAVT REM MODIFIED
	TOPSOIL AND HYDROSEEDING
	PROP CONCRETE
	PROP HMA

2	CITY OF MUSKEGON OFFICE OF THE CITY ENGINEER	CJ REESE PARKING AREA	REMOVALS AND PROPOSED	Drawn: K PARKER Revisions: 1. _____ 2. _____ 3. _____ Date: _____	Date: _____ NOTES:
---	-------------------------------------------------	--------------------------	--------------------------	----------------------------------------------------------------------------------	-----------------------

SHELDON PARK PARKING AREA

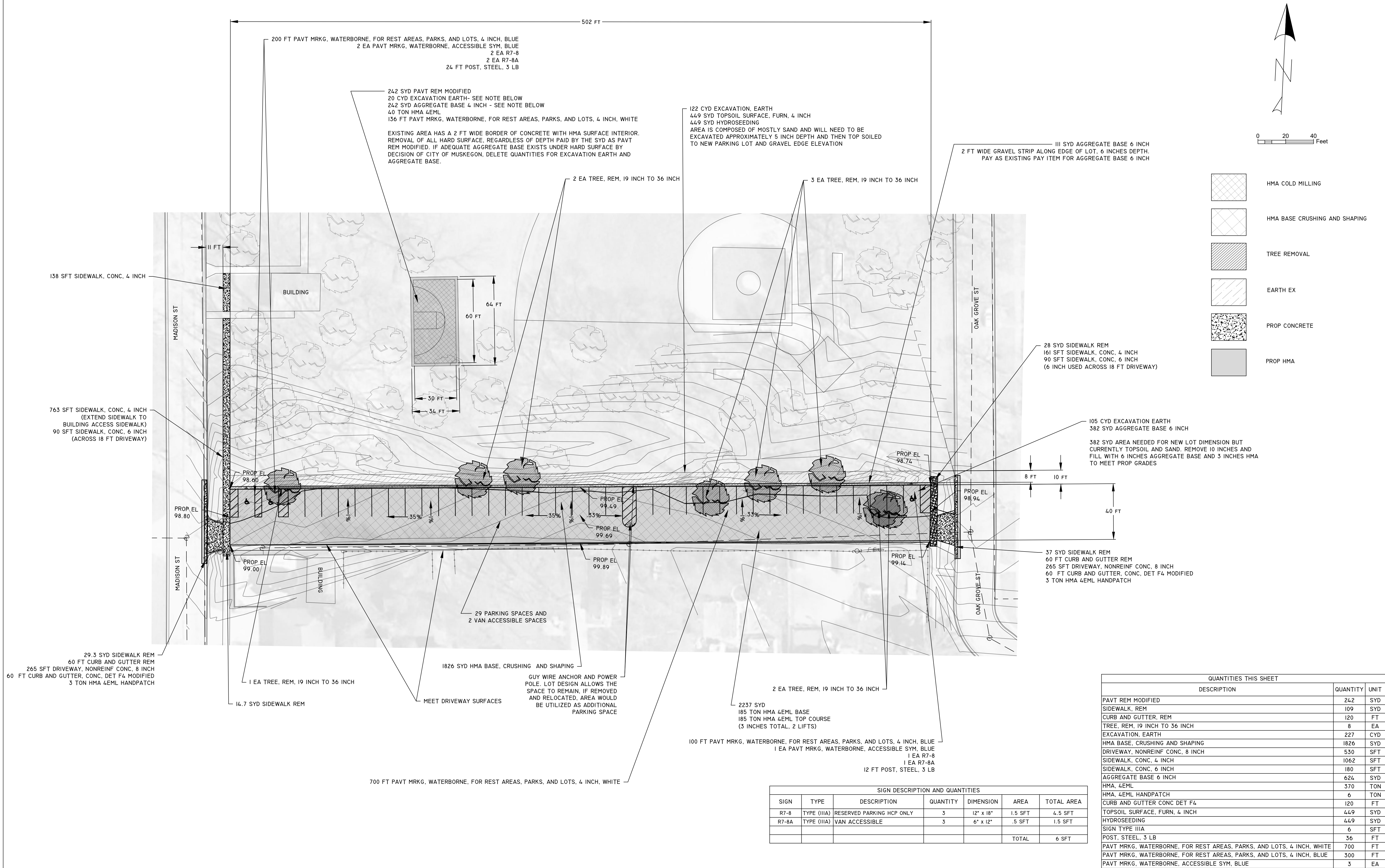

QUANTITIES THIS SHEET		
DESCRIPTION	QUANTITY	UNIT
PAVT REM MODIFIED	242	SYD
SIDEWALK, REM	109	SYD
CURB AND GUTTER, REM	120	FT
TREE, REM, 19 INCH TO 36 INCH	8	EA
EXCAVATION, EARTH	227	CYD
HMA BASE, CRUSHING AND SHAPING	1826	SYD
DRIVEWAY, NONREINF CONC, 8 INCH	530	SFT
SIDEWALK, CONC, 4 INCH	1062	SFT
SIDEWALK, CONC, 6 INCH	180	SFT
AGGREGATE BASE 6 INCH	624	SYD
HMA, 4EML	370	TON
HMA, 4EML HANDPATCH	6	TON
CURB AND GUTTER CONC DET F4	120	FT
TOPSOIL SURFACE, FURN, 4 INCH	449	SYD
HYDROSEEDING	449	SYD
SIGN TYPE IIIA	6	SFT
POST, STEEL, 3 LB	36	FT
PAVT MRKG, WATERBORNE, FOR REST AREAS, PARKS, AND LOTS, 4 INCH, WHITE	700	FT
PAVT MRKG, WATERBORNE, FOR REST AREAS, PARKS, AND LOTS, 4 INCH, BLUE	300	FT
PAVT MRKG, WATERBORNE, ACCESSIBLE SYM, BLUE	3	EA

BEUKEMA PLAYFIELD PARKING AREA



CONSTRUCTION NOTE- GRADES ARE NOT ESTABLISHED ON STATE PLANE. BENCHMARKS NOTED ON PLAN. ELEVATION CONTOURS SHOWN ARE EXISTING.

QUANTITIES THIS SHEET		
DESCRIPTION	QUANTITY	UNIT
CURB AND GUTTER, REM	60	FT
AGGREGATE BASE, CONDITIONING, SURPLUS AND UNSUITABLE REM LM	174	CYD
EXCAVATION, EARTH	28	CYD
AGGREGATE BASE, LM	104	CYD
SIDEWALK, CONC, 4 INCH	790	SFT
HMA, 4EML	160	TON
TOPSOIL SURFACE, FURN, 4 INCH	182	SYD
HYDROSEEDING	182	SYD
PAVT MRKG, WATERBORNE, FOR REST AREAS, PARKS, AND LOTS, 4 INCH, WHITE	34.2	FT

EXISTING AND REMOVALS

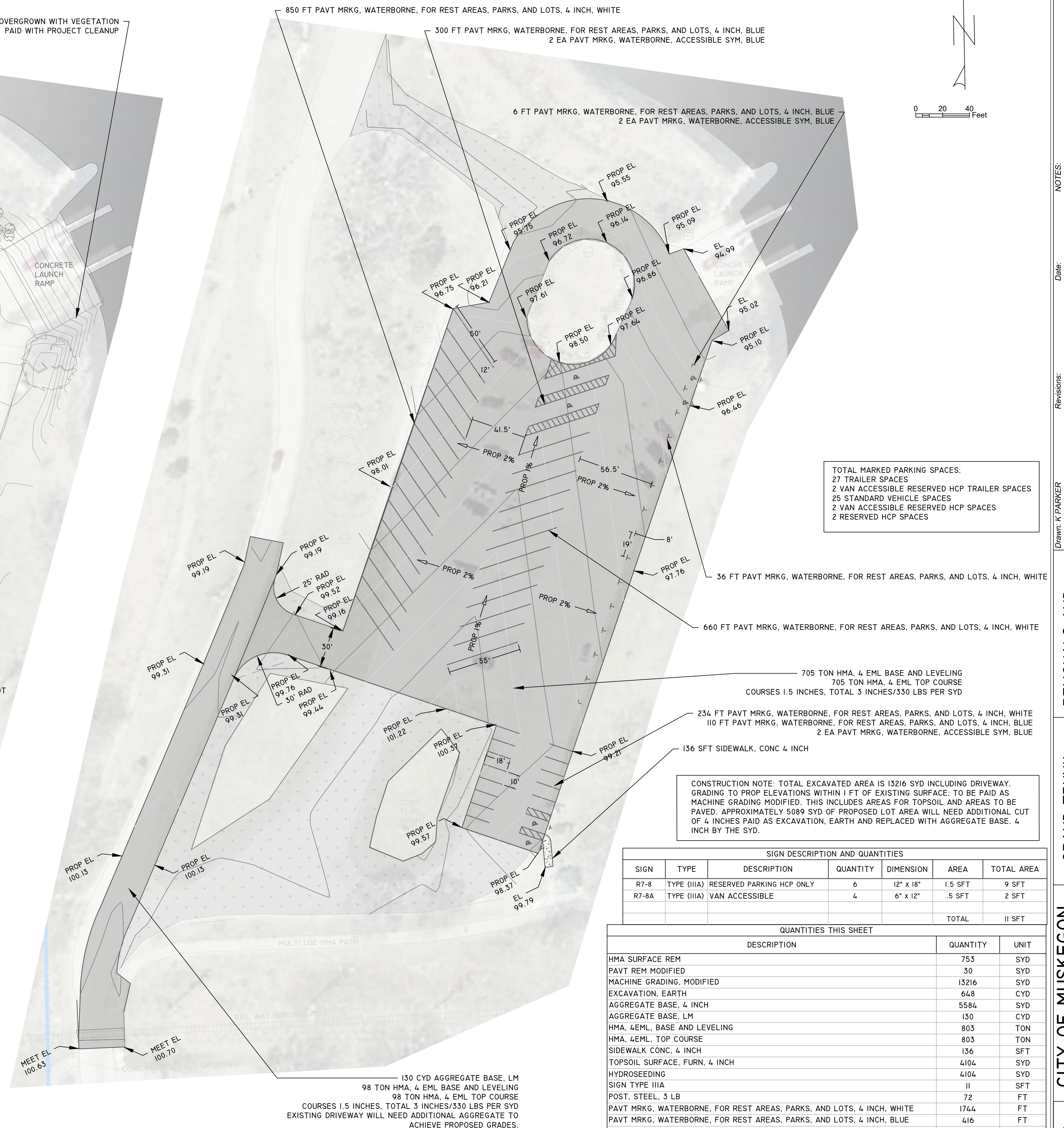

SIGN DESCRIPTION AND QUANTITIES						
SIGN	TYPE	DESCRIPTION	QUANTITY	DIMENSION	AREA	TOTAL AREA
R7-8	TYPE (IIIA)	RESERVED PARKING HCP ONLY	6	12" x 18"	1.5 SFT	9 SFT
R7-8A	TYPE (IIIA)	VAN ACCESSIBLE	4	6" x 12"	.5 SFT	2 SFT
					TOTAL	11 SFT
QUANTITIES THIS SHEET						
DESCRIPTION					QUANTITY	UNIT
PMA SURFACE REM					753	SYD
PAVT REM MODIFIED					30	SYD
MACHINE GRADING, MODIFIED					13216	SYD
EXCAVATION, EARTH					648	CYD
AGGREGATE BASE, 4 INCH					5584	SYD
AGGREGATE BASE, 1M					130	CYD
PMA, 4EML, BASE AND LEVELING					803	TON
PMA, 4EML, TOP COURSE					803	TON
SIDEWALK CONC, 4 INCH					136	SFT
TOPSOIL SURFACE, FURN, 4 INCH					4104	SYD
HYDROSEEDING					4104	SYD
SIGN TYPE IIIA					11	SFT
POST, STEEL, 3 LB					72	FT
PAVT MRKG, WATERBORNE, FOR REST AREAS, PARKS, AND LOTS, 4 INCH, WHITE					1744	FT
PAVT MRKG, WATERBORNE, FOR REST AREAS, PARKS, AND LOTS, 4 INCH, BLUE					416	FT
PAVT MRKG, WATERBORNE, ACCESSIBLE SYM, BLUE					6	EA

5

CITY OF MUSKEGON
OFFICE OF THE CITY ENGINEER

GRAND TRUNK
REMOVALS AND
PROPOSED

Revisions:
1. Drawn: K. PARKER
2. Date: 1/17/2025
3. Checked:
Date:

NOTES